

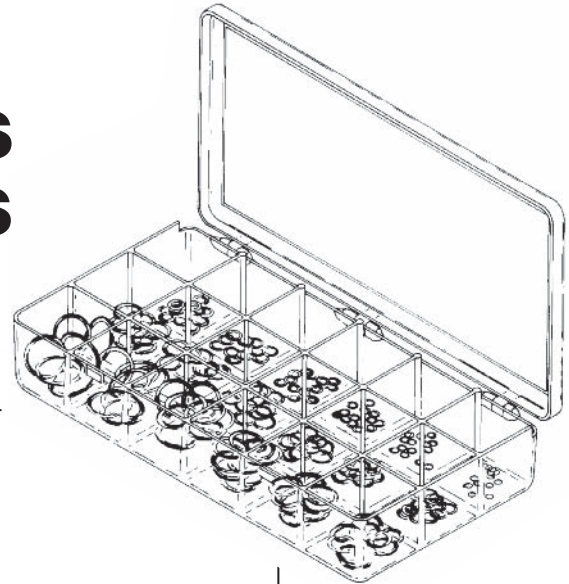

O-RINGS, INSTALLATION TOOLS AND REMOVAL TOOLS TO FIT A-DEC



RPI PART #RPK483 AUTOCLAVEABLE O-RING KIT

- Kit includes 18-compartment carrying case (RPI Part #RPB417)
- O-rings are also sold separately in quantities indicated below

RPI PART #	OEM #	X-SEC	ID	OD	IND PART #	MATERIAL	DURO	QTY
RPO307	035 048 01	.070	.114	.254	AS568A-006	EPDM	70	12
RPO326	033 014 01	.070	.489	.629	AS568A-014	Viton	75	12
RPO444	034 019 01	.070	.801	.941	AS568A-019	EPDM	70	12
RPO484	033 003 01	.060	.056	.176	AS568A-003	Viton	75	12
RPO485	034 013 01	.070	.426	.566	AS568A-013	EPDM	70	12
RPO486	034 002 01	.050	.042	.142	AS568A-002	EPDM	70	12
RPO487	034 003 01	.060	.056	.176	AS568A-003	EPDM	70	12
RPO488	034 014 01	.070	.489	.629	AS568A-014	EPDM	70	12
RPO489	035 033 01	.070	.101	.241	AS568A-005	EPDM	70	12
RPO490	034 018 02	.070	.739	.879	AS568A-018	EPDM	70	12
RPO491	034 107 00	.103	.206	.412	AS568A-107	EPDM	70	12
RPO492	035 029 01	.070	.208	.348	AS568A-009	Silicone	70	12
RPO493	034 001 00	.038	.032	.108	Custom	EPDM	70	12
RPO494	035 049 01	.040	.176	.256	Custom	EPDM	70	12
RPO495	035 009 01	.062	.400	.520	Custom	Viton	75	12
RPO496	035 050 01	.040	.070	.150	Custom	EPDM	70	12
RPO497	035 030 01	.040	.176	.256	Custom	Viton	75	12
RPO498	034 012 01	.070	.364	.504	AS568A-012	EPDM	70	12

RPI PART #RPK483
AUTOCLAVEABLE
O-RING KIT

RPI Part #RPK481 OEM Part # 009 013 00

O-RING INSTALLATION TOOLS

- Three sizes
- Accommodates O-rings with ID of .029" through .208"
- Stainless steel
- ~1-3/4" lg.

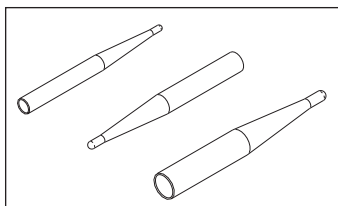

RPI Part #RPK581 OEM Part # (No OEM Part # Available)

O-RING REMOVAL TOOLS

- Pointed ends for hard to reach areas
- Blunt ends for larger surfaces
- Brass (to reduce potential o-ring groove damage)
- ~5-1/2" lg.

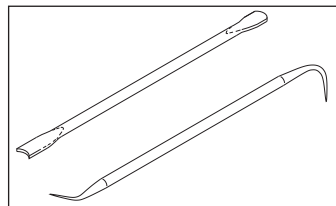

RPI Part #RPL090 OEM Part #98-0090-00

HIGH TEMP LUBRICANT

- 5 per package
- 1/2 gram per unit
- Non-silicone lubricant
- Temperature range: -40° to +400°F (-40° to +204°C)
- MSDS and Technical Data sheet available on RPI website

